

## APA OKLAHOMA CHAPTER BOARD OF DIRECTORS

### EXECUTIVE COMMITTEE:

President: Susan F. Connors, AICP [susan.connors@normanok.gov](mailto:susan.connors@normanok.gov)

Vice President: Danielle Barker [danielle.barker@bethanyok.org](mailto:danielle.barker@bethanyok.org)

Treasurer: Erik Enyart, AICP [eenyart@tannerbaitshop.com](mailto:eenyart@tannerbaitshop.com)

Secretary: Jill Hall Ferenc, AICP [jferenc@claremorecity.com](mailto:jferenc@claremorecity.com)

PDO: James Wagner, AICP [JWagner@incoq.org](mailto:JWagner@incoq.org)

Past President: Paula J Dennison, AICP [pdennison@stillwater.org](mailto:pdennison@stillwater.org)

### AT-LARGE, OU & SPA MEMBERS:

At Large 1: Jennifer Gates, AICP [jgates@cityoftulsa.org](mailto:jgates@cityoftulsa.org)

At Large 2: Tori Raines [vraines@cpyi.com](mailto:vraines@cpyi.com)

At Large 3: Charles Leider, AICP [clwleider@gmail.com](mailto:clwleider@gmail.com)

At Large 4: Nancy Warring [newarring@cityofbartlesville.org](mailto:newarring@cityofbartlesville.org)

At Large 5: Chad Denson [cdenson@choctawcity.org](mailto:cdenson@choctawcity.org)

Legislative Liaison: Justin Henry [Justin.Henry@omes.ok.gov](mailto:Justin.Henry@omes.ok.gov)

University Liaison: Vacant

Student Liaison: Kimberly Gilbert

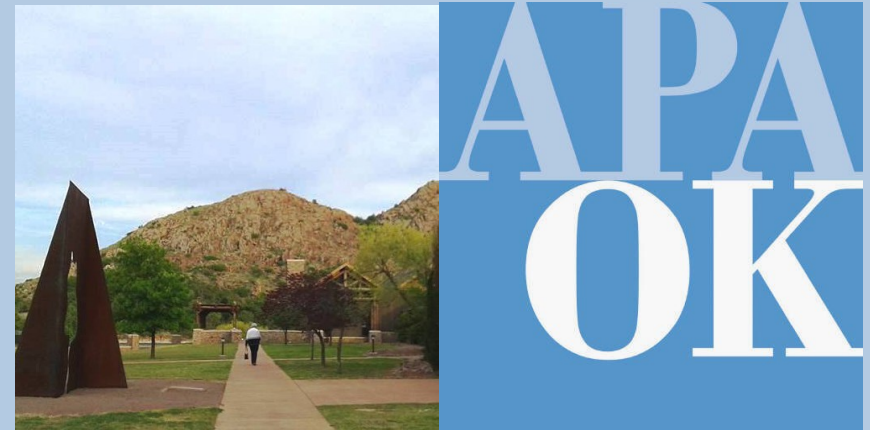

## Moving Mountains

2016 Oklahoma APA Annual Conference and Meeting

Quartz Mountain Resort Arts & Conference Center

Lone Wolf, OK

September 25-27, 2016

## PRESIDENT'S MESSAGE

Welcome to the 2016 Oklahoma APA Annual Conference and Meeting!

This year's theme "Moving Mountains" is recognizing the importance of planning in our State coupled with the financial and political challenges that we each face on a day to day basis.

We hope that you will find inspiration and motivation from a great variety of sessions that highlight some great planning projects and initiatives that represent the diversity of our field. Our Keynote Lunch by Mr. Edmonson will provide a perspective of the impact SQ 777 could have on planning in Oklahoma.

Also not to be missed is our Membership Meeting Monday morning, where you can learn more about the Oklahoma Chapter of the APA. In addition, our newly reinstated Awards Program will be presenting the 2016 Awards at the dinner Monday night.

There are many great things happening at this short conference and we are glad you can join us!

Sincerely,  
Susan Connors, AICP  
President

## THANK YOU TO OUR 2016 CONFERENCE SPONSORS!

### Appalachians



### Ozarks

ADG, Inc.

Halff Associates, Inc.

### Wichita

Crafton Tull

Ellen Stevens, Ph.D., P.E., PLLC

Guy Engineering

## PROGRAM CONTENTS

Certification Maintenance Credits	1
Area Map	1
Conference Site Logistics	2
Schedule-At-A-Glance	3
Session and Special Event Descriptions	5
2016 APA Oklahoma Chapter Board of Directors	15

## CERTIFICATION MAINTENANCE CREDITS

After the conference has occurred, log your credits at <https://planning.org> and follow these steps:

1. Login using your APA ID# and password.
2. Scroll down to CM Log and Select "Log CM Credits"
3. Select "CM Search" on sidebar
4. Using the search option box type in Event # **9107326** and click "Go"
5. From the results, find your sessions and select "Add to My Log"
6. Please rate, add a comment (optional), and click on the Ethics statement
7. Click submit and the CM credits should appear in your CM log



## AREA MAP

Located 17 miles north of Altus in the Wichita Mountains of southwestern Oklahoma near the Texas border, Quartz Mountain Arts and Conference Center and Nature Park is ideally located just two and a half hours from Oklahoma City.

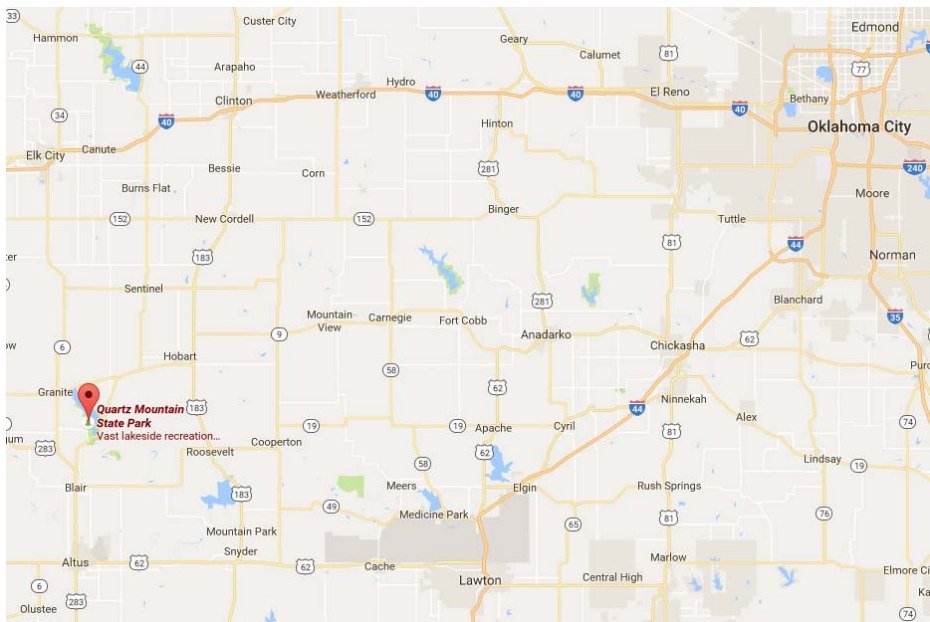

## CONFERENCE SITE LOGISTICS

### Quartz Mountain Resort Arts & Conference Center

#### Parking

Parking for the conference is available around the main building.

#### Conference

Registration, check-in and all conference sessions and events will be located within the main building. In the conference program you will see where each session or event will be located.

#### Exhibitors

Visit the exhibitors near the registration table Sunday and Monday!

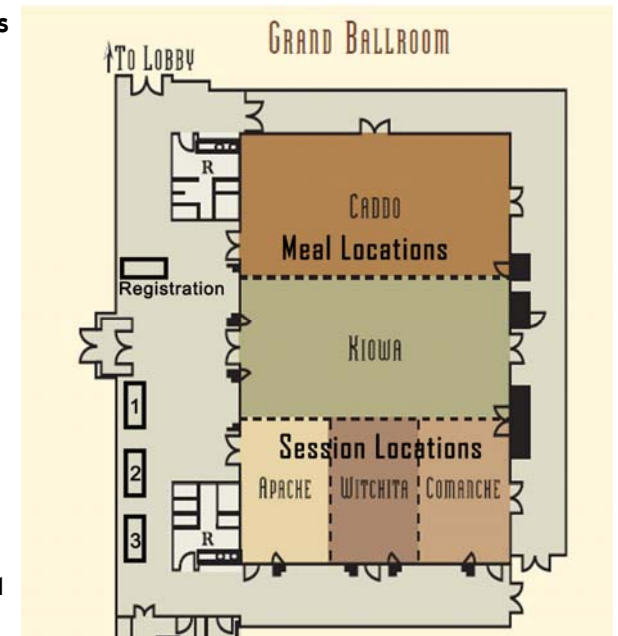

## SCHEDULE-AT-A-GLANCE

Sunday, September 25

3:00 - 5:30 PM	Exhibit Hall by Grand Ballroom	Registration and Check-in
5:30 - 7:30 PM	Sundance Patio	Opening Reception

Monday, September 26

7:30 - 5:00 PM	Exhibit Hall—Grand Ballroom	Registration and Check-in
8:00 - 8:45 AM	Comanche	Membership Meeting
9:00 - 10:00 AM	Comanche	Urban Infill in Rural Oklahoma: Affordable Housing in a Small Town
	Wichita	Creating a Downtown from Scratch - Placemaking Success in Owasso
	Apache	In Search of Clean Water in Uganda: Building Solutions Through Community-Based Planning
10:15 - 11:45 AM	Comanche	Planning Ethics
	Wichita	Attracting People and Possibilities with Public Art and Public Space
	Apache	Planning for Healthy Communities
12:00 - 1:30 PM	Kiowa	Keynote Lunch - SQ 777: Impact on our State's Ability to Plan
1:45 - 3:15 PM	Comanche	Life after Reed
	Wichita	Oklahoma Cultural Districts and Placemaking
	Apache	Re-integrating Design, Planning, and Public Health
3:30 - 5:00 PM	Comanche	TIFs and BIDs - FYI
	Wichita	Planning to Preserve: Preservation as a Planning Tool
	Apache	Improving Resiliency to Natural Hazards: Planning Strategies and Recovery Efforts
5:30 - 7:30 PM	Kiowa	Awards Dinner

Tuesday, September 27

9:00 - 11:00 AM	Walking Tour	Altus, Oklahoma: Revitalizing the Jackson County Courthouse Square
8:30 - 10:00 AM	Comanche	The 2015 Oklahoma Affordable Housing Market Study
	Wichita	Quantitative and Qualitative Approaches to Bicycle Planning and Encouragement
	Apache	Putting Plans Together and Planning for Water
10:15 - 11:45 AM	Comanche	Is the Role of Aesthetics Underrated in Small-town and Rural Planning?
	Wichita	Rightsizing Streets for People and Development
	Apache	Before and After the Adoption of the Comprehensive Plan





## SESSION AND SPECIAL EVENT DESCRIPTIONS

### SUNDAY, SEPTEMBER 25

#### REGISTRATION, CHECK-IN, EXHIBIT BOOTHS 3:00 - 5:30 PM

*Exhibit Hall by Grand Ballroom*

Check-in or register for the conference in the exhibit hall outside the Grand Ballroom located in the main building. Also visit the Exhibit Booths for great information from our sponsors!

#### OPENING RECEPTION 5:30 - 7:30 PM

*Sundance Patio*

Join us light appetizers and a drink on the Sundance Patio overlooking Altus Lake.



Sundance Patio

### MONDAY, SEPTEMBER 26

#### REGISTRATION, CHECK-IN, EXHIBIT BOOTHS 7:30 AM - 5:30 PM

*Exhibit Hall by Grand Ballroom*

#### MEMBERSHIP MEETING 8:00 - 8:45 AM

*Comanche*

Join us in celebrating planning success and help plan for 2017.

### SESSIONS 9:00 - 10:00 AM

#### Urban Infill in Rural Oklahoma: Affordable Housing in a Small Town

*Comanche*

Hear from a developer and architect that specialize in large scale residential construction outside of the metropolitan areas. Explore three examples of building numerous residential units in existing older neighborhoods of towns with populations below 25,000. Discuss the cost advantages of residential infill along with market disadvantages and ways to mitigate those issues. Address design and site concerns with urban infill. Learn about some of the financing streams available at the local, state, and federal level to help develop residential units in smaller towns. Hear about the logistics and construction issues during development and the management and sales issues post construction.

Lance Windel, Owner, LW Development, LLC; Elizabeth Windel, Principal Architect, SDG Architects

#### Creating Downtown from Scratch

*Wichita*

Owasso, OK had a Main Street, mostly just in name. Owasso was missing that special place where people can walk around, shop locally and feel like they are a part of the community. They were missing a downtown. Unlike most cities in Oklahoma, Owasso had no old buildings that needed to be unboarded and dusted off, they had nothing downtown except buildings with no character. They could dream, design, and build our downtown from scratch! It started with public feedback, then the creation of an overlay district, leading to great participation and now the dreams are coming true. Owasso's downtown renaissance is underway, come hear our story!

Bronce Stephenson, MPA, Director of Community Development, City of Owasso

#### In Search of Clean Water in Uganda: Building Solutions Through Community-Based Planning

*Apache*

In June 2016, faculty and students from the University of Oklahoma traveled to Northern Uganda for a service learning project surrounding water use issues. The interdisciplinary project included planning, architecture, and engineering students collaborating with local communities to better understand local water systems and opportunities to improve local quality of life. This presentation by planning and architecture students will introduce the community-based methods used during the project as well as discuss identified issues, findings, and recommended solutions for addressing the water concerns in Northern Ugandan communities. Students will show how this method can be used in Oklahoma.

Jane Wyrick, AICP, RCPL Student, University of Oklahoma; Kimberly Gilbert, RCPL Student, University of Oklahoma; Stephen Johnson, RCPL Student, University of Oklahoma; Christopher Le, Architecture Student, University of Oklahoma

## SESSIONS 10:15 - 11:45 AM

### Planning Ethics

#### *Comanche*

Planners face a variety of ethical challenges in their career. This session will discuss ethical challenges as seen from a Director and new professional perspective. Come learn the various ethical challenges that have been seen from different professionals perspectives.

Susan Connors, AICP, Planning and Community Development Director, City of Norman; Paula Dennison, AICP, Development Services Director, City of Stillwater; Danielle Barker, Community Development Specialist, City of Bethany

### Attracting People and Possibilities with Public Art and Public Space

#### *Wichita*

"It is difficult to design a space that will not attract people; what is remarkable is how often this has been accomplished." -William H. (Holly) Whyte

Great places, especially those with great public art, can provide many direct and indirect benefits to a community. There are benefits that are obvious like cultural tourism, but there are also benefits that are more indirect like building a community's economic and social capacity, improving a community's health and assisting with crime prevention. Come learn how to initiate or expand a public art program in your community. Topics include: Types of public art; Benefits of public art; How to fund public art; How and why to regulate public art; and, How to develop a long-range plan for public art in your community.

Robbie Kienzle, Arts Liaison, Office of Arts and Cultural Affairs, City of Oklahoma City and Planning Commissioner, City of Shawnee; Susan Atkinson, AICP, Senior Planner, Planning & Redevelopment Division, City of Oklahoma City

### Planning for Healthy Communities

#### *Apache*

This session will discuss how Oklahoma City and Tulsa have incorporated public health into the development of comprehensive plans and the development review process in order to promote healthier communities. Through a health impact assessment and development review rubric, planners and public health professionals are creating a more comprehensive 'Health in all Planning' approach. Participants will gain a greater understanding of how to incorporate health in the planning process and how local health departments can be a resource for healthy living. Speakers will share experience regarding the development of tools, lessons learned, and successes in incorporating health into their cities.

Luisa Krug, Chronic Disease Epidemiologist, Tulsa Health Department; John Tankard, Associate Planner, City of Oklahoma City Planning Department; Joani Dotson, Policy and Health Analytics Manager, Tulsa Health Department; Carrie Blumert, Community Partnership Liaison, Oklahoma City -County Health Department

## KEYNOTE LUNCH 12:00 - 1:30 PM

### SQ 777: Impact on our State's Ability to Plan *Kiowa*

Join us for lunch and hear Drew Edmondson, former Oklahoma State Attorney General and District Attorney, on "SQ 777 Right To Farm" bill that will be voted on in November. If passed, the proposed state constitutional change would prohibit the state regulatory agencies from passing laws or adopting rules and regulations that negatively impact the rights of farmers and ranchers. Hear more about the background on the law, the potential unintended consequences of this law, and how it could affect planners in Oklahoma.

Drew Edmondson, Former Oklahoma State Attorney General and District Attorney



Mr. Drew Edmondson

## SESSIONS 1:45 - 3:15 PM

### Life after Reed

#### *Comanche*

This session will detail the decision in Reed v. Town of Gilbert regarding local sign regulation. The presentation will focus on the meaning of content neutrality and provide examples of codes that meet and/or fail to meet these requirements. The presenter will work with participants to draft content neutral local sign regulations. Upon conclusion, a discussion will commence about unresolved issues in this field of the law.

Dawn Jourdan, AICP, Texas A & M University

### Oklahoma Cultural Districts and Placemaking

#### *Wichita*

Oklahoma communities possess an array of cultural influences and assets. The Oklahoma Arts Council's Cultural District Initiative helps communities identify how local art and culture can be leveraged to promote economic development. Examples from OU Institute of Quality Communities' collaborations highlight how placemaking strategies can be rooted in local cultures.

Shane Hampton, Director, OU Institute for Quality Communities; Hope Mander, Associate Director, OU Institute for Quality Communities; Ron Frantz, Director of Small Town Studios, OU Institute for Quality Communities; Christina Beatty, Community Arts Director, Oklahoma Arts Council

## Re-Integrating Design, Planning, and Public Health

### Apache

Learn about the efforts of the University of Oklahoma's Community Health and Environmental Design (CHED) initiative to bring together design, planning, and medical professionals to improve community health through better environmental design of buildings, neighborhoods, and cities. Hear case studies of various multi-disciplinary education, research, and service projects started by the CHED since its inception five years ago. Studies include research and creative work with the OU School of Community Medicine, service projects such as the renovation of the Oklahoma Juvenile Justice Library, and various Active Transportation projects for schools and neighborhoods. The presentation concludes with a prospectus of future opportunities to engage the community, heal our environments, and improve individual health.

Shawn Michael Schaefer, AICP, Director, Urban Design Studio, OU College of Architecture; Michael Birkes, Professor of Practice, OU College of Architecture; Amanda Yamaguchi, Assistant Planner, City of Broken Arrow

## SESSIONS 3:30 - 5:00 PM

### TIFs and BIDs - FYI

#### Comanche

With national and state funding for municipal priorities shrinking, it is increasingly important for Oklahoma planners to avail themselves of two helpful tools already available - Tax Increment Financing (TIFs) and Business Improvement Districts (BIDs). Over 40 TIF Districts have been created throughout Oklahoma, in communities of all sizes, to address issues of economic development or blight remediation. BIDs have been used to address a gamut of issues, ranging from support of traditional Main Street activities to the construction of a baseball stadium. Learn about the state statutes that enable them, what each tool can achieve, and how communities have used them to implement their planning goals.

AJ Kirkpatrick, AICP, Director of Urban Planning, ADG; Jeff Sabin, Associate Attorney, Center for Economic Development Law; Kathryn Walker, Assistant City Attorney, City of Norman

### Planning to Preserve: Preservation as a Planning Tool

#### Wichita

Historic Preservation is often viewed as limited to pretty old buildings and neighborhoods. It can also be seen as a hurdle for cities or developers to jump over. This presentation will discuss the ways that historic preservation can be an integral part of the stabilization, redevelopment, and revitalization of neighborhoods and commercial areas in communities with case studies from Oklahoma City and Ardmore. Preservationists and planners will discuss the benefits of preserving historic places, and provide an overview of federal, state and local tools available to encourage historic preservation. Also learn ways to incorporate historic preservation into a decision- and goal-making process about larger revitalization and redevelopment efforts.

Katie Friddle, Historic Preservation Officer, City of Oklahoma City; Susan Atkinson, AICP, Senior Planner, City of Oklahoma City; Stephanie Keyser, City Planner, City of Ardmore Development Services



**Move a Mountain!**

- City Design
- Participatory Planning
- Community Health
- Urban Research
- Service Learning

The Master of Science in Architectural Urban Studies

Tulsa's Turkey Mountain Urban Wilderness Area

**OUUDS**  
The University of Oklahoma Urban Design Studio

For Information: Shawn Schaefer, AICP CUD  
918.660.3493  
sschaefer@ou.edu

<http://tulsagrad.ou.edu/studio>  
or visit us on facebook 

weekend and evening classes at OU-Tulsa

 The University of Oklahoma is an equal opportunity institution.



Blair, OK



## Improving Resiliency to Natural Hazards: Planning Strategies and Recovery Efforts

### *Apache*

This session will include an interactive discussion linking the analysis of the state's extreme weather and climate events as well as examples of how planners are actively involved in natural hazard resiliency efforts. There will be further discussion of 12 building code modifications that were completed as a result of the May 2013 tornado in the City of Moore. Performance of these building code modifications when subjected to winds associated with an EF2 tornado will also be discussed. The development of "Smart Code" to a suburban community as applied to transform an area that was blighted and within the tornado area will be further discussed.

Elizabeth Jones, AICP, Community Development Director, City of Moore; Lisa Holliday, Associate Professor, University of Oklahoma; Leah Kos, Climate Assessment Specialist, Southern Climate Impacts Planning Program; Danielle Barker, Community Development Specialist, City of Bethany

## AWARDS DINNER 5:30 - 7:30 PM

### 2016 Oklahoma APA Awards Presentation

#### *Kiowa*

Join us for dinner and the presentation of the 2016 Oklahoma APA Awards!

## TUESDAY, SEPTEMBER 27

### WALKING TOUR 9:00 - 11:00 AM

#### Altus, Oklahoma: Revitalizing the Jackson County Courthouse Square

*Transportation is not provided.*

*Walking Tour Meets at Just Brew It Coffee House 106 West Cypress, Altus, OK*

In the spring of 1992, downtown supporters successfully applied and joined the Oklahoma Main Street network, a historic preservation-based, economically-focused downtown revitalization program. Over the past 24 years, leaders followed the Main Street 4-Point Approach of Organization, Promotion, Design, and Economic Restructuring. What was the weakest side of the square, is now a bustling mix of businesses, services, and various activities. As leaders removed false fronts they discovered the



Altus, OK

original architecture of this southwest Oklahoma town. Altus recently approved their own "MAPs" (Metropolitan Area Projects), which included a number of large-scale projects in the community. Come learn how design and planning, combined with organization and promotion, created an award-winning downtown revitalization program for a mid-size Oklahoma town.

Ron Frantz, Associate Professor, The University of Oklahoma College of Architecture

## SESSIONS 8:30 - 10:00 AM

### The 2015 Oklahoma Affordable Housing Market Study

#### *Comanche*

The Statewide Affordable Housing Market Study was commissioned by the Oklahoma Department of Commerce and the Oklahoma Housing Finance Agency. Funded by the U.S. Department of Housing and Urban Development through the Community Development Block Grant - Disaster Recovery program, the study builds upon an initial 2001 statewide housing study and incorporates additional topics and datasets, including: Disaster Resiliency, Homelessness, Fair Housing, and Lead-Based Paint Hazards. The results allow planners, municipalities, developers, and non-profit agencies to effectively target their resources to address the state's affordable housing and disaster preparation needs. Overall, Oklahoma is expected to need 43,942 housing units for ownership and 22,879 housing units for rent through the year 2020. Cities should be working to update and maintain emergency management plans, and promote housing choice for homeless, low-income, and working Oklahomans.

Meghan Wieters, PhD, AICP, Assistant Professor, University of Oklahoma; Steven Shepelwich, Federal Reserve Bank of Kansas City; Byron DeBruler, Vice President, DeBruler Inc.; David Puckett, Senior Director, Integra Realty Resources

### Quantitative and Qualitative Approaches to Bicycle Planning and Encouragement

#### *Wichita*

The Lawton MPO has implemented a strategy for introducing bicycling into the community where such recreation/transportation had previously been avoided in favor of more automobile-friendly improvements. By working to simultaneously provide bicycle infrastructure as well as efforts to relay information to the public through television and print PSAs, face-to-face communications at Open Streets events, and brochures--Lawton is progressing toward a more dynamic transportation network.

The City of OKC Planning Department is finalizing the City's first bicycle and pedestrian master plan - bikewalkokc. OKC has used a comprehensive process to identify the areas of interest for proposed bicycle and sidewalk improvements. At the same time, OKC has kicked-off a multi-modal transportation safety campaign.

Travis Estep, Transportation Planner, Lawton Metropolitan Planning Organization; Matt Sandidge, Senior Planner, City of Oklahoma City; John Tankard, Associate Planner, City of Oklahoma City

## Putting Plans Together and Planning for Water

### *Apache*

This two-part session will focus on the importance of long-range comprehensive planning in Oklahoma municipalities. The first half of the session will be a panel discussion with city staffs about their experiences in the comprehensive planning process from RFP/RFQ through implementation of a final plan. The second half of the session will focus on including water resources in the planning process. Water planning is critical in developing sustainable communities. Water planners will discuss water-related challenges municipalities have faced and will discuss why and how this emerging topic in planning is so important for Oklahoma and the region.

Daniel Harrison, AICP, Senior Planner, Freese and Nichols, Inc.; Lissa Gregg, Water Resources, Freese and Nichols; Anaïs Starr, AICP, Planner, City of Norman; Chad Denson, Development Service Director, City of Choctaw

## SESSIONS 10:15 - 11:45 AM

### Is the Role of Aesthetics Underrated in Small-town and Rural Planning?

#### *Comanche*

This session concerns three small towns in Oklahoma struggling for survival and what role design might play in their revival. Cases of small town revivals that have been successful nationwide will be featured. The presentation will include the economics of creating a more aesthetic environment such as the proposed dedication of a certain percentage of farm subsidies (redirected from mega-corporate farms) to enhance rural and small town environments. The role of community center/libraries will be also be featured. Finally, the design of facilities, signage, roadways and parks that has the greatest impact on community spirit at the least cost will be illustrated.

J. Clare Woodside, AICP, Senior Architect, Director of Planning, Benham

### Rightsizing Streets for People and Development

#### *Wichita*

Creating more complete streets is a focus for many in the planning field. However the notion of what makes a street complete continues to evolve as communities become larger and more diverse. In this session, an urban planner, traffic engineer, and landscape architect discuss their experiences on best practice projects which includes roadway space reallocations, road diets, parking reconfigurations, and bicycle and pedestrian facilities. The goal of this session is for participants to learn how traffic engineering and urban design can be better balanced to create streets that function for all users of a corridor including daily commuting, commerce, deliveries, and special events.

Kevin St Jacques, Senior Transportation Engineer, Freese and Nichols, Inc.; Wendy Shabay, Senior Urban Planner, Principal, Freese and Nichols, Inc.; Randy Entz, AICP, City of Oklahoma City

### Before and After the Adoption of the Comprehensive Plan

#### *Apache*

We know we need a Comprehensive Plan but how do we know when we need a new one? What do we do with it after its adopted? Hear from different size communities on different steps taken to begin to write or update a comprehensive plan, identifying implementation opportunities, and measuring change and validity of the plan over time.

Jennifer Gates, AICP, Planner III, City of Tulsa; Chad Denson, Development Service Director, City of Choctaw; Nancy Warring, Grants Administrator, City of Bartlesville

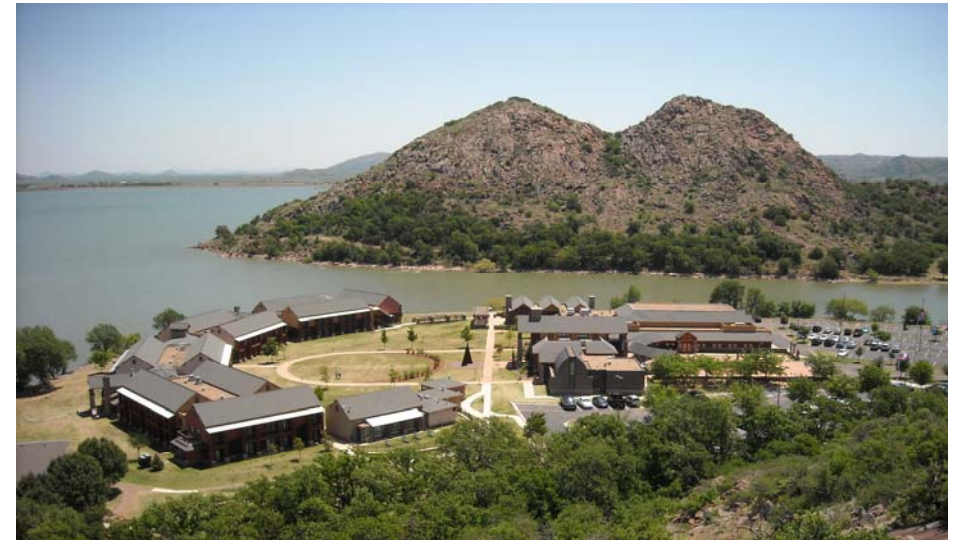

Quartz Mountain Resort